

Alead

BLUETOOTH WIRELESS LiveMicrophone & Receiver Set P/N ALMICRX5C2XXX

USER GUIDE



Declaration of Conformity: We declare that product ALMICRX5C2XXX conforms to the R&TTE Directive 1999/5/RC.

CE 0678

FCC ID:TNZNSRXRM3C2XXX
FCC ID:TNZNSRX3C2XXX



INTRODUCTION

The LiveMicrophone & Receiver Set(LiveMICRX2) allows capturing the source of audio wirelessly with LiveMIC2 wireless microphone. This wireless microphone & receiver provides the unique low latency to allow users to have well listening or recording remote voice without delayed.

GETTING STARTED

Unpack the package carefully and confirm that you have all of parts as shown below.



LiveMIC2



Receiver(RX2)



USB charging
cable X2



3.5mm TRRS
audio cable



External microphone

Please check the contents carefully and contact your local dealer immediately if anything is missing or damaged.

PRODUCT OVERVIEW

See image below. Please note some models will differ slightly in style, colour and the functionality may vary according to their specifications.



(RX2)



(LiveMIC2)

CHARGING

Before using the LiveMIC2 and RX2, you must charge both for approximately 2 hours. After fully charged, the battery provides up to 6 hours of voice talk time and up to 100 hours of standby time .

Plug USB charging cable into LiveMIC2 and RX2 mini USB connector. Plug the other side of USB charging cable into a powered USB connector.

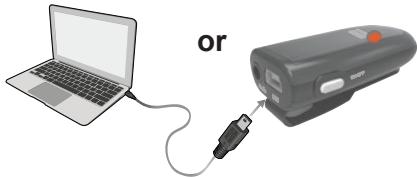

When charging, the **amber LED** will be lighted. When charging is completed, the **amber LED** will be turn off or dim.

TURN ON AND PAIRING

You need to pair both LiveMIC2 and RX2 when both first time to use together.

1. On LiveMIC2, press and hold the ON/OFF button for about 2 seconds until **blue LED** blinking quickly.

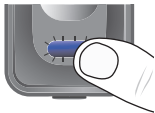

LiveMIC2 type A
pairing mode

2. On RX2, press and hold the ON/OFF button for 2 seconds until **blue LED** blinking quickly.



3. Both LiveMIC2 and RX2 will pair and connect each other automatically. The **blue LED** of both devices will change to flash slowly (approx once every two seconds) after completed pairing and connecting.

※ The LiveMIC2 supports two pairing modes. The type A and type B pairing mode have different LED indication. Please ensure you are in type A pairing mode during the pairing.

● Switch to desired Type A mode

Select the type A mode by slide A/B mode switch before turn on LiveMIC2.

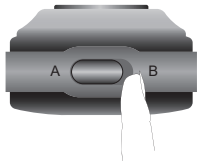

TURN OFF

Press and hold the ON/OFF button for about 2 seconds, the **amber LED** on LiveMIC2 and RX2 will stay on for about 1 second and then device will be turn off, release the ON/OFF button.

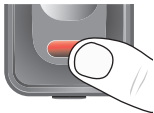

OPERATION

Using for remote voice and communication

After connected with the LiveMIC2, RX2 will receive the audio or voice wirelessly.

Fit 3.5mm plug audio cable to RX2,

Plug your 3.5mm audio plug of audio cable into the RX2's audio jack and another side connects to "Audio In" of your audio speaker, home stereo, car stereo, PA systems, voice recorder or headphone. Then, you can listen and enjoy audio or voice wirelessly.



LiveMIC2

"Speaker"



voice



RX2

"Listener"

Using for listening or recording remote voice

Connect to audio output of RX2 to speakers or iPad/iPhone to listen or record remote voice wirelessly.

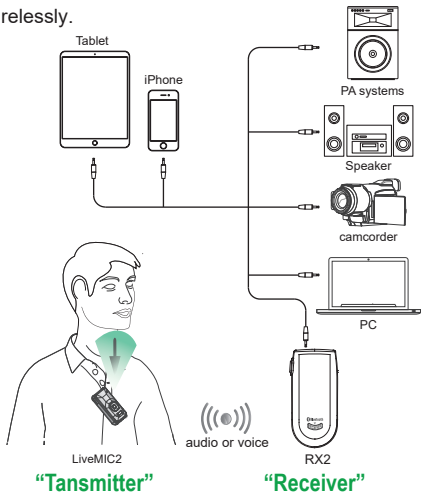

Using microphone on LIVEMIC2

The LiveMIC2 supports internal and external microphone

◆ Using internal Uni and Omni directional microphone

Put LiveMIC2 close to the source of the sound within 8 inches to captured the best sound quality.



Press the microphone select button, the correspond internal microphone will be used.



Uni Mic Switch



Omni Mic Switch

- Both unidirectional and omnidirectional microphones have their advantages and disadvantages. The important thing is to know the application of the microphone in use to know which would be better for the given situation around.

-  Unidirectional (Cardioid) microphone is used that the target sound source pick up directly in front of the microphone, and all other sounds from sides are largely rejected.



-  Omnidirectional microphone will pick up sound from all directions or sides around the microphone. Users can speak into any side of the microphone.

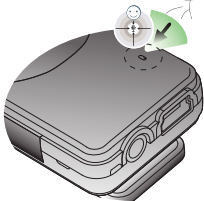



 Unidirectional

 Omnidirectional

◆ Using external microphone

Plug the 3.5mm audio plug of external microphone into the LiveMIC2 audio jack and select the external MIC on the select button. LiveMIC2 will disable internal MIC and use the external MIC for sound capturing.



External Mic Switch

- This type of external microphone is suitable for LiveMIC2

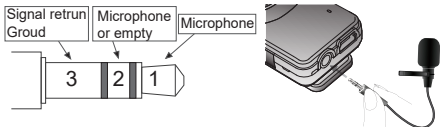

Adjust microphone gain and mute LiveMIC2

The G+/G- buttons is used to adjust the microphone input gain. Each microphone gain can be adjusted when it is using, and the gain will be stored after setting.

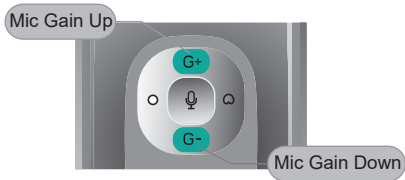

- G+ and G- : Single press to increase and decrease the microphone gain.
- Mute: Press and hold the G- for about a second to mute the microphone, then to press the G+ to unmute.

Adjusting the RX2 audio volume

- **To increase the audio volume**

While listening audio, click the ON/OFF button once to increase the volume by one step. Repeat this procedure until you reach the desired level.

- **To decrease the audio volume**

While listening audio, quick click the ON/OFF button two times continuously to decrease the volume by one step. Repeat this procedure until you reach the desired level.

Reduce audio delay with FastStream

The LiveMIC2 and RX2 support low latency audio with FastStream.

VISUAL INDICATION

The POWER/MODE/AUDIO LED can also indicate the status of LiveMIC2 and RX2 working statuses.

Statures	Indication
Charging	amber LED is on
Not Connected	blue LED low speed flash, approx. every 5 seconds
Connected	blue LED middle speed flash
RX2 and LiveMIC2 in pairing mode	blue LED flash quickly
Power On	blue LED flash
Power Off	amber LED flash once

TROUBLESHOOTING

Problem	Likely Cause / Solution
<p>LiveMIC2 and RX2 does not reconnect. Lost Connection. blue LED flashes at 5 second intervals.</p>	<p>LiveMIC2 and RX2 were out of range for more than 30 seconds. Switch both LiveMIC2 and RX2 off and switch on again to reconnect or press button on microphone to reconnect.</p>
<p>LiveMIC2 can not pair with RX2</p>	<p>Ensure both devices are within 10m distance range and LiveMIC2 using in type A mode.</p>

CUSTOMER SERVICE INFORMATION

For other Alead or Nolan Bluetooth products or support, please view our website – www.aleadinc.com, www.nolan-sys.com or email info@aleadinc.com, info@nolan-sys.com or contact your local representative.

DISCLAIMER

Whilst every effort has been made to ensure that the information in this manual is accurate and complete, no liability will be accepted for any errors and/or omissions made. The manufacturer reserves the right to make changes and improvements to the specifications and features of the hardware and firmware of the products described in this document without prior notice. Reproduction, transfer, distribution or storage of part or all of the contents in this document in any form is prohibited without prior permission of the manufacturer. All trademarks acknowledged.

ENVIRONMENT

Do not throw this electrical device away with the normal household waste at the end of its life, but hand it in at an official collection point for recycling. By doing this you will help to preserve the environment.

